

Approximate Locations of Traffic Calming Devices on Augusta Street

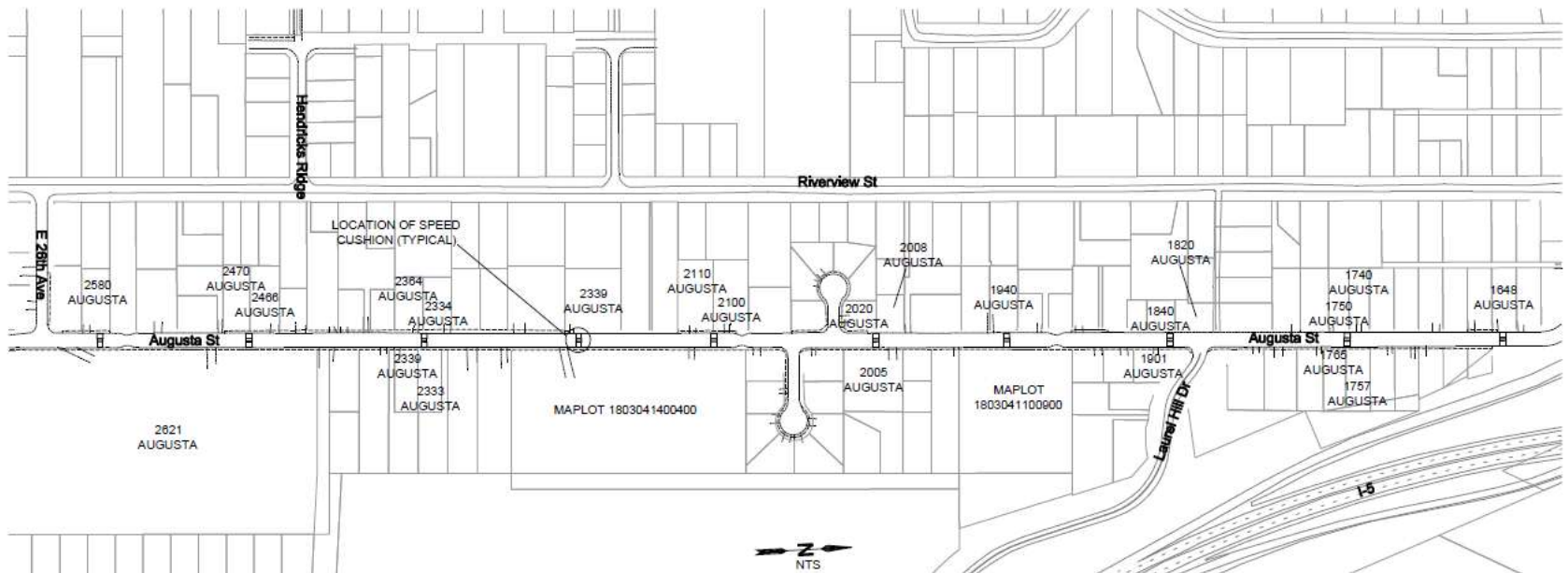

Traffic calming devices called speed cushions are being installed in response to concerns about speeding traffic expressed by Augusta Street residents and the Laurel Hill Valley Citizens Association.

Speed Cushions:

- 3-inches high
- 14-16 feet long (grooved to allow wide-tracked emergency vehicles to avoid some of the vertical deflection)
- Spaced 300 to 400 feet apart

For more information, please contact:

Rob Inerfeld
Transportation Planning Manager
City of Eugene Public Works Engineering
541-682-5343
rob.inerfeld@ci.eugene.or.us
www.eugene-or.gov/augusta